

J-3/J-4 Parts Diagram

Should you ever need replacement parts for your Jiffy Steamer, you may purchase them separately. Use this convenient diagram and parts list to identify any part you may need. Please reference the Jiffy Steamer part number, model number and serial number when ordering. **Call for pricing.**

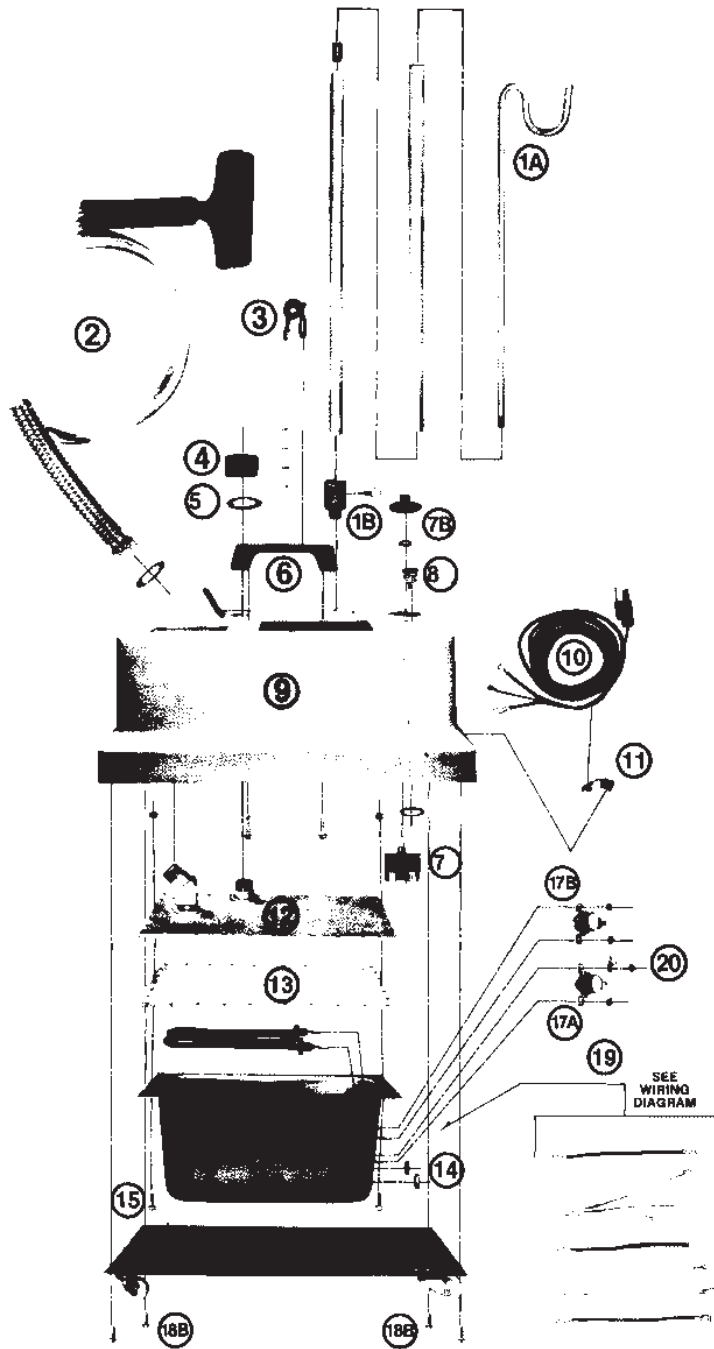

Item #	Key #	Part Description	Price
0031	1a,b	Hose hanger rod set and adaptor complete	\$ 30.00
0041	1 b	Base adaptor	\$ 5.00
0251	2 a	Plastic head/handle hose attachment complete	\$ 58.00
0254	2 b	Metal head and wood handle hose attachment complete	\$ 81.00
0253	2 c	Plastic steam head and handle replacement kit	\$ 25.00
0269	2 d	Wood handle only with brass screw	\$ 8.25
0045	3	Water level stick	\$ 3.50
0049	4	Water fill cap	\$ 7.50
0006	5 a,b	Beauty ring (2)	\$ 1.75
0054	6	Housing handle with screws (3 pcs.)	\$ 8.25
0199	7 a,b	Switch and knob	\$ 14.00
0127	8 a,b	Neon pilot light with lock ring	\$ 5.00
0131	8 b	Lock ring only for pilot light	\$ 0.35
0133	10	Cord set with strain relief	\$ 11.00
0146C	11	Cord strain relief	\$ 1.75
0058	12	Boiler tank lid with fittings	\$ 32.00
0061	13 a	Boiler tank sealer (liquid - 2.8 fl. oz.)	\$ 5.50
0062	13 b	Boiler tank sealer (liquid - 10.1 fl. oz.)	\$ 10.00
0063	14	Heating element with washers and nuts	\$ 32.00
0071	15	Tank screw set (30)	\$ 7.00
0074A	16 b	Boiler tank - Aluminum (12 1/2 in. long) for J-4	\$ 90.00
0203	17 a	Preheat thermostat	\$ 10.00
0204	17 b	Steam thermostat	\$ 10.00
0016	18 a	Bottom plate with casters	\$ 21.00
0017	18 b	Bottom plate screws (4)	\$ 1.00
0018	18 c	Caster set (4)	\$ 7.50
0155	19	Internal wire set	\$ 10.00
0195	20	Fusible link clamp	\$ 1.75
0158	21	Fusible link wire with insulated lug	\$ 3.50

NOTE: THESE PRICES SUBJECT TO CHANGE WITHOUT NOTICE.

Jiffy Steamer Company, LLC

 jiffysteamer.com Manufacturing Plant:
 info@jiffysteamer.com 4462 Ken-Tenn Highway
 1.731.885.6690 Union City, Tennessee 38261
 1.731.885.6692 United States of America

J-3/J-4 Wiring Schematic



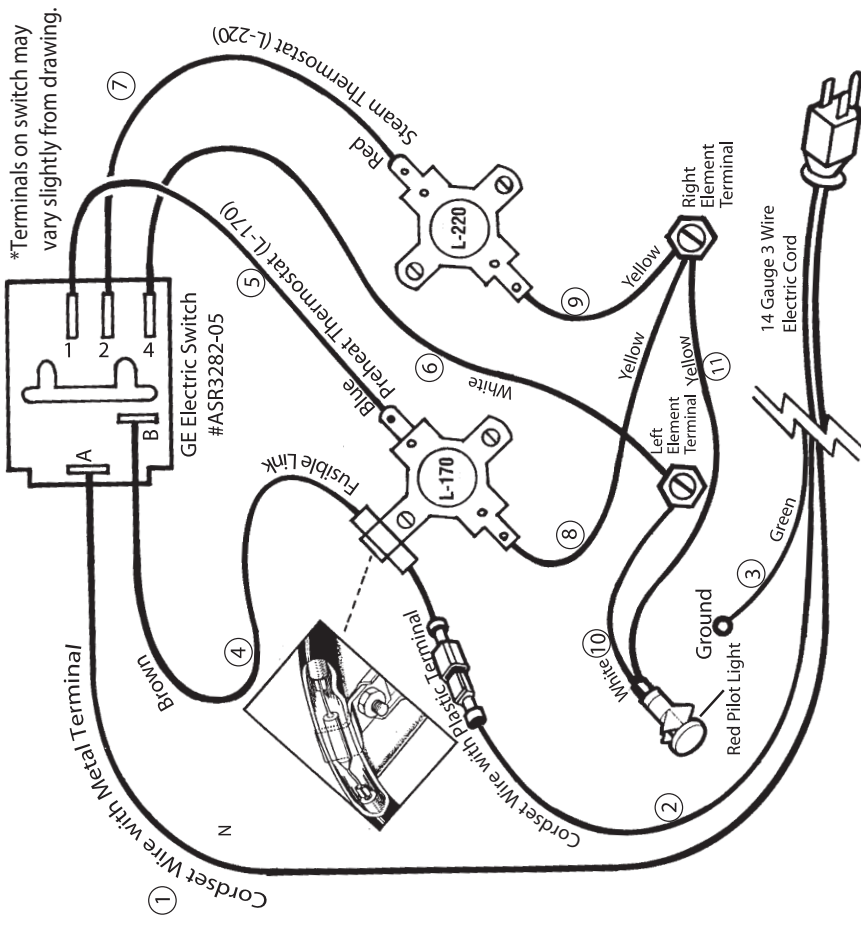

Before attempting any repair on a Jiffy Steamer product, make sure that it is unplugged from the outlet. If you have any questions, please contact our repair department at 1-800-525-4339 between 7:30 AM - 4:00 PM Central Time.

Caution:
Insure that the power cord is unplugged from the electrical outlet before attempting to repair your Jiffy Steamer.

1. Metal Terminal to (A) switch.
2. Plastic Terminal to (4) fuse wire.
3. Ground to outer housing of steamer.
4. Fuse wire to (B) on switch.
5. From top of preheat thermostat to (1) on switch.
6. From left side of element to (4) on switch.
7. From top of steam thermostat to (2) on switch.
8. From bottom of preheat thermostat to right side of element.
9. From right side of element to the bottom of steam thermostat.
10. Light to left side of element.
11. Light to right side of element.



Jiffy Steamer Company, LLC

 jiffysteamer.com Manufacturing Plant:
 info@jiffysteamer.com 4462 Ken-Tenn Highway
 1.731.885.6690 Union City, Tennessee 38261
 1.731.885.6692 United States of America