

# J-3/J-4 Parts Diagram

Should you ever need replacement parts for your Jiffy Steamer, you may purchase them separately. Use this convenient diagram and parts list to identify any part you may need. Please reference the Jiffy Steamer part number, model number and serial number when ordering. **Call for pricing.**

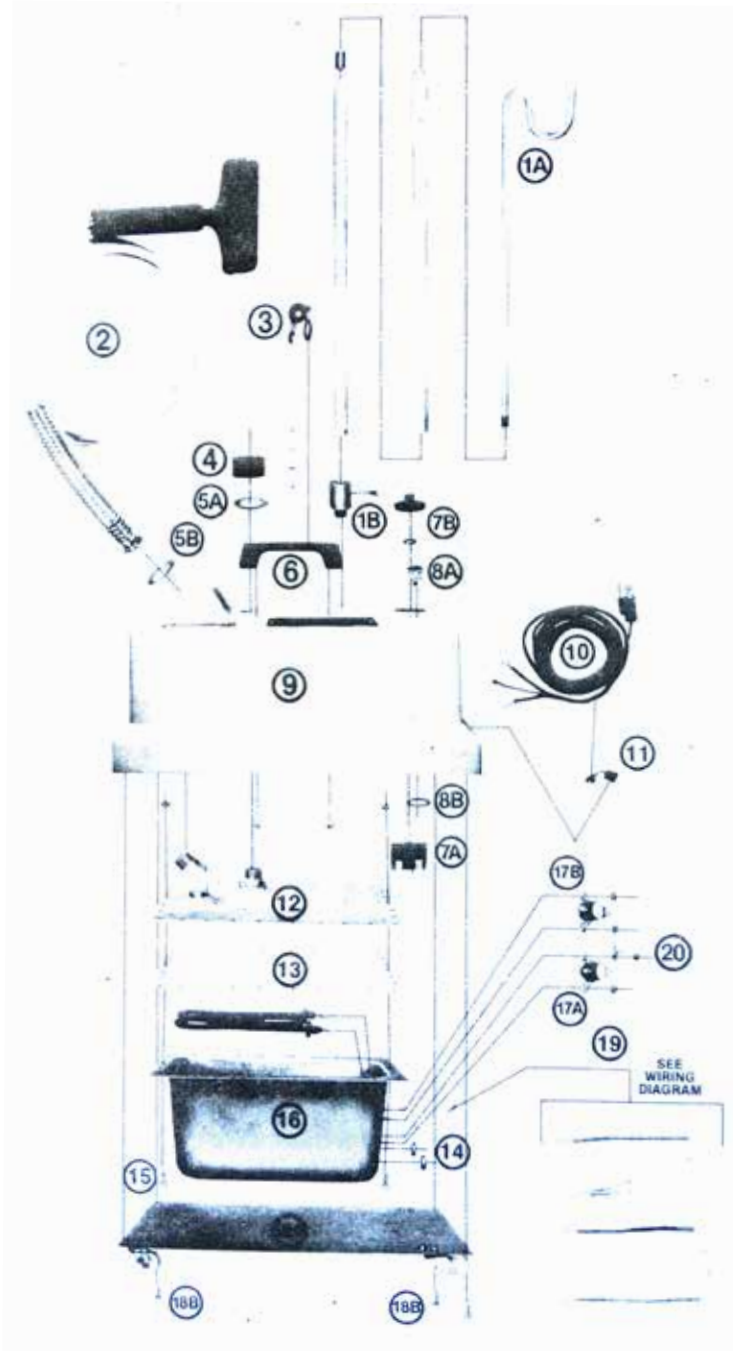

## Key # Part Description

- 1a,b Hose hanger rod set and adaptor complete
- 1 b Base adaptor
- 2 a New style plastic hose attachment complete
- 2 b Old style metal head and wood handle hose attachment complete
- 2 c Plastic steam head and handle replacement kit
- 2 d Wood or plastic handle only
- 3 Water level stick
- 4 Water fill cap
- 5 a, b Beauty ring (2)
- 6 Housing handle with screws (3 pcs.)
- 7 a, b Switch and knob
- 8 a, b Neon pilot light with lock ring
- 8 b Lock ring only for pilot light
- 9 J-3 case aluminum housing
- 10 Cord set
- 11 Cord strain relief
- 12 Boiler tank lid with fittings
- 13 a Boiler tank sealer (liquid - 2.8 fl. oz.)
- 13 b Boiler tank sealer (liquid - 10.1 fl. oz.)
- 14 Heating element with washers and nuts
- 15 Tank screw set (30)
- 16 a Boiler tank - Stainless Steel (13 1/8 in. long)
- 16 b Boiler tank - Aluminum (12 3/8 in. long)
- 17 a Preheat thermostat
- 17 b Steam thermostat
- 18 a Bottom plate with casters
- 18 b Bottom plate screws (4)
- 18 c Caster set (4)
- 19 Internal wire set
- 20 Fusable link clamp
- 21 Fusable link wire with insulated lug

NOTE: these prices are current as of January 1, 1992. Prices subject to change without notice.

## Jiffy Steamer Company, LLC

-  [jiffysteamer.com](http://jiffysteamer.com)
- Manufacturing Plant:
-  [info@jiffysteamer.com](mailto:info@jiffysteamer.com)
- 4462 Ken-Tenn Highway
-  1.731.885.6690
- Union City, Tennessee 38261
-  1.731.885.6692
- United States of America

